

SHOOTING TRAINER PRO(RECURVE)

The Shooting Pro trainer is designed for recurve bow, and is equipped with a simulated arrow shaft and a simulated clicker system. So that the archer can clearly and accurately feel the complete process of recurve bow shooting. The equipment of simulation clicker makes the training more standardized and scientific.

Recommendations:

1. Please don't shoot at people or animals during use.
2. When the shooting trainer is used in the limb weight less than 22 pounds, the movement speed of the simulated arrow shaft is slow.
3. The shooting trainer needs to be fixed with two screws. Make sure there are two screw positions on the arrow side of the bow. If there is only one screw position, please contact the dealer to buy accessories: auxiliary bracket. Otherwise, it will be lead to serious accidents.

◆ NOTICES: PLEASE CONFIRM FIRST BEFORE USING

1. Whether the screw at the end of the arrow is tightened.
2. Whether the position of the arrow shaft is at the center of the bow launching or the center is slightly outside.
3. Whether the relative angle between the shaft and the bowstring is nearly vertical.
4. Whether the shaft is entangled by foreign matters.
5. Please keep the front air outlet clean and check whether there is foreign matter blocking.

Product installation

1. Remove the plunger from the riser.

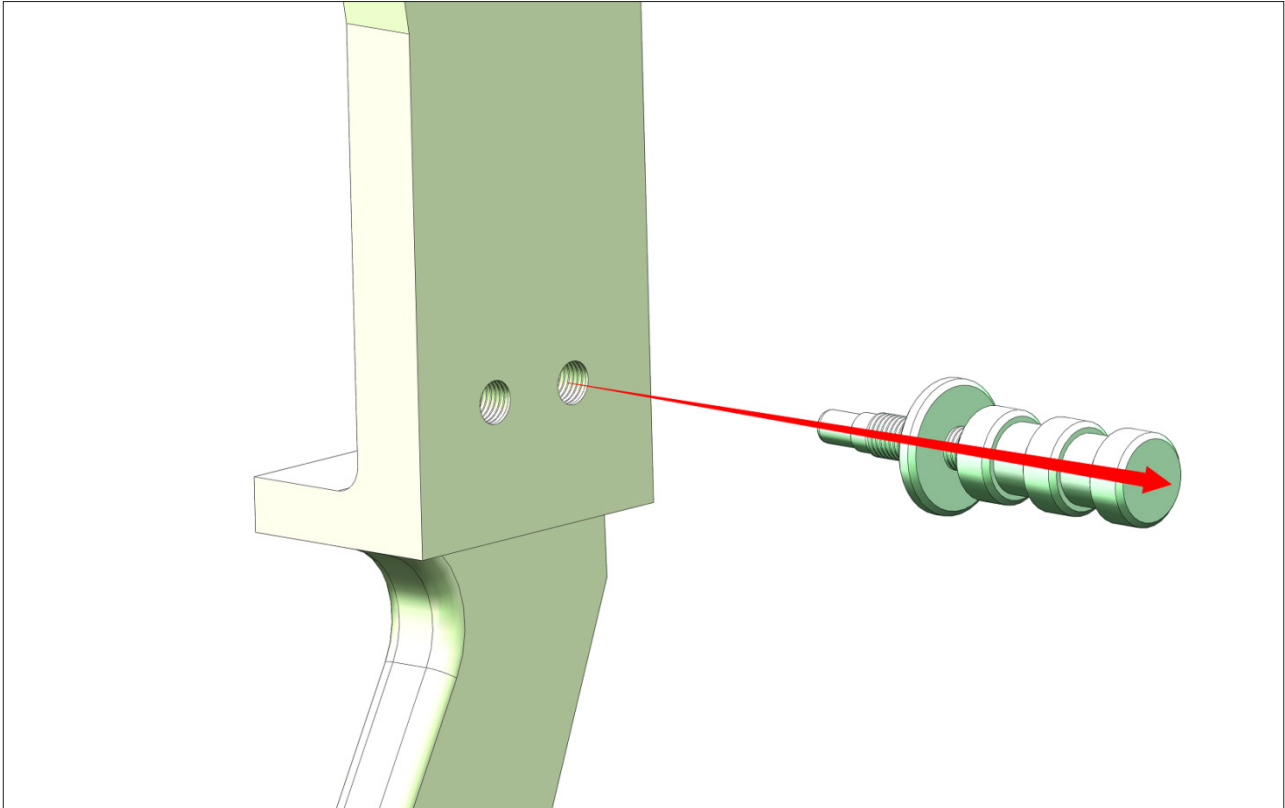

2. Using two 5/16-24 UNF screws to lock the trainer on the riser.

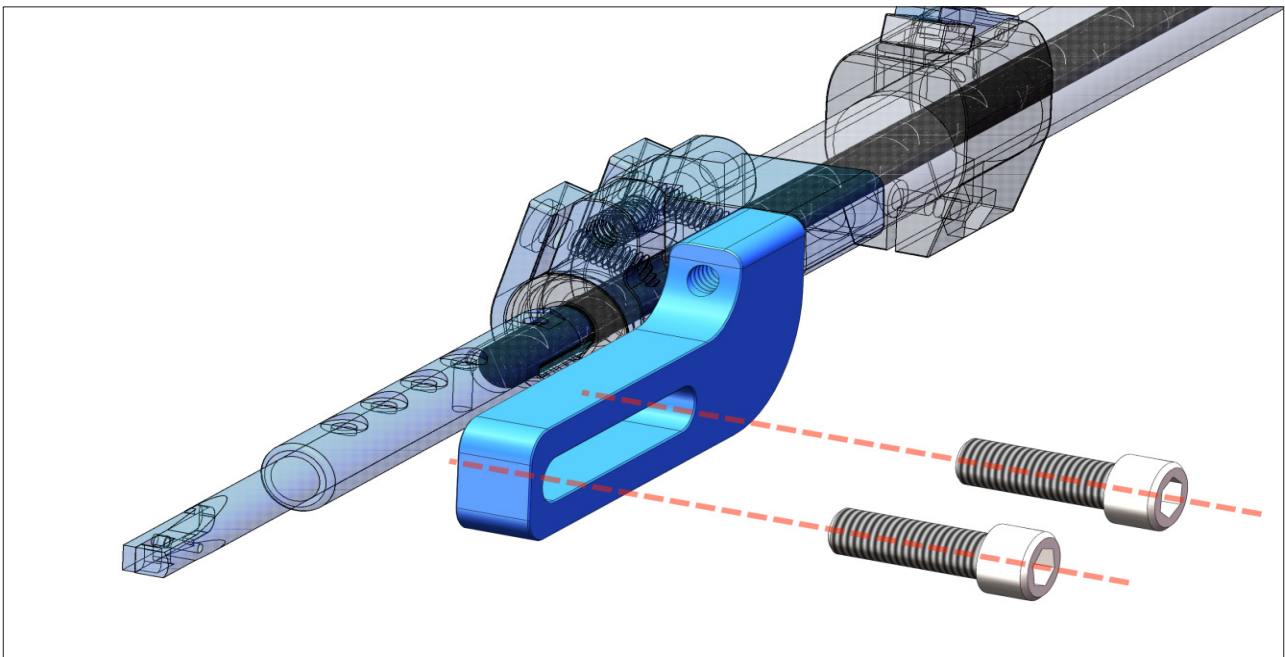

3. Adjust the 1/4-20 UNC screw of the cantilever and pipe clamp, and adjust the position of the cantilever and pipe clamp. Make sure the position of the arrow shaft is at the center of the bow window launch or slightly outside the center.

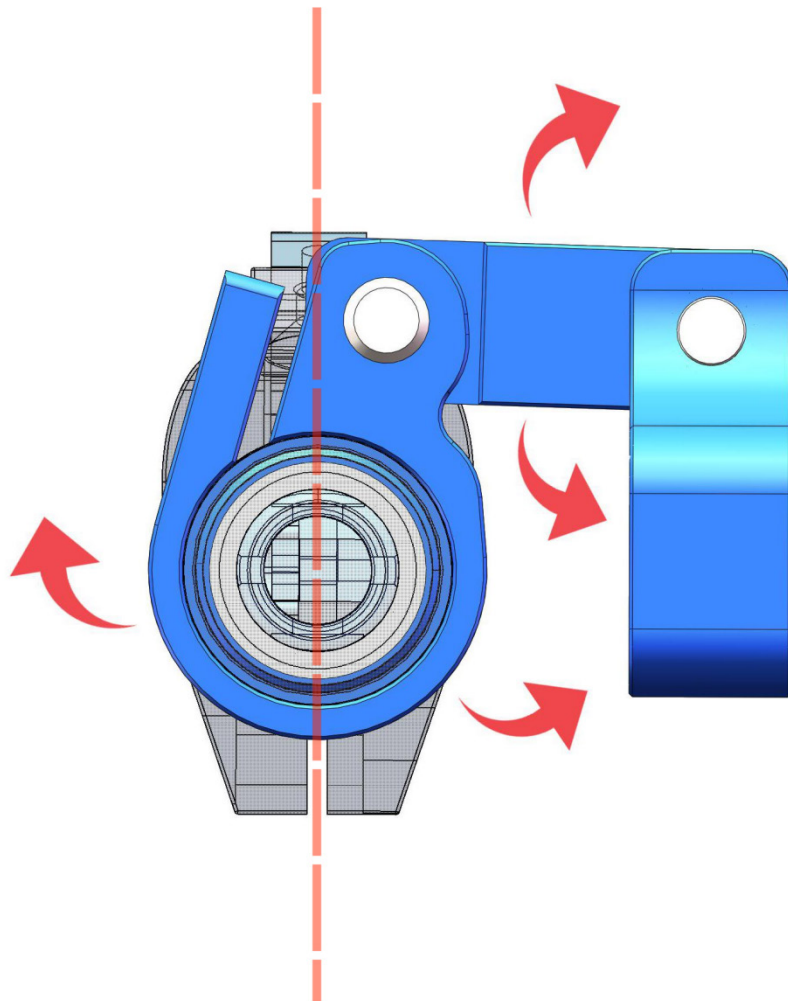

The center of the bow

4. Draw out the simulation shaft, loosen the compression screw of the tail, and buckle the tail to the position of the arrow point. Stick the compression piece and tighten the compression screw.

◆ **Note:** please check whether the hold down screw is tight before installation and use.

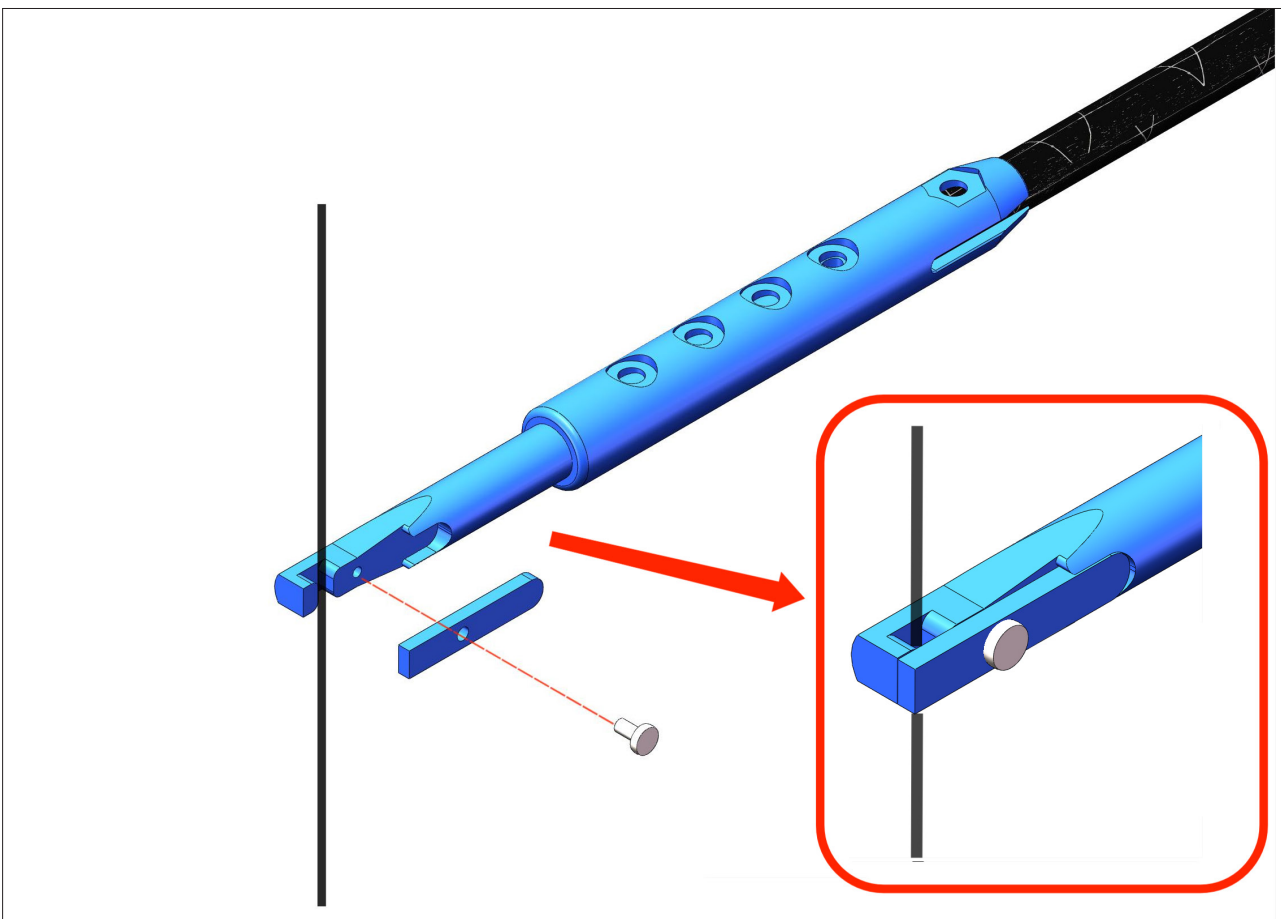

5. Adjust the angle of base, make the opposite angle between imitate arrow shaft and bow string of practise device close to vertical. (Need adjust again after each one time installed.)

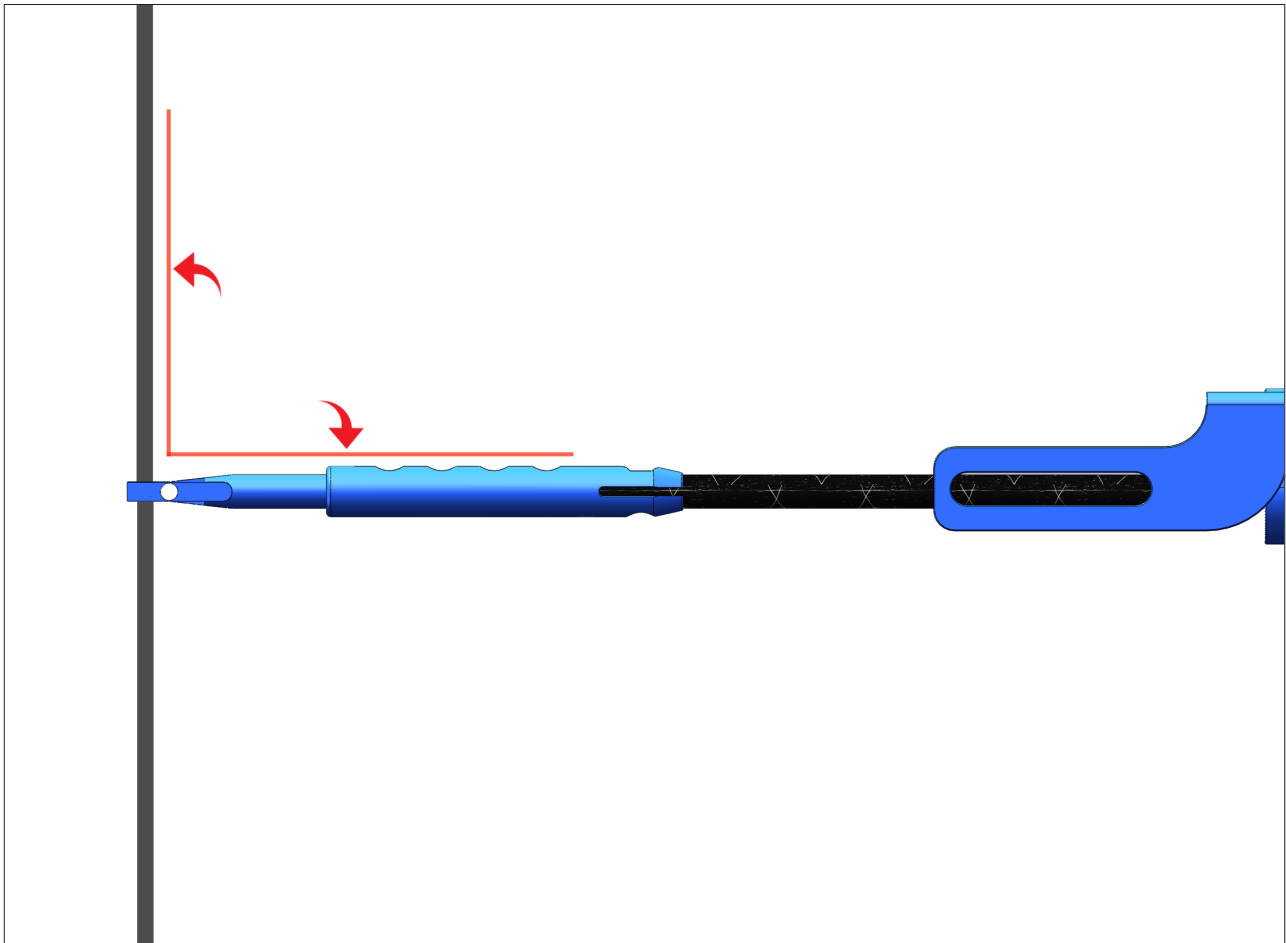

Should do best to adjust the imitate arrow shaft position vertical to the bow string, favour to reduce load of imitate arrow shaft and extend working life.

◆ **Attention**

Please confirm first before used:

1. Whether the compression screw of the arrow nock is tightened
2. Whether the position of the arrow shaft is located in the center of the bow or the center is slightly outside.
3. Simulate whether the relative angle between the shaft and the bowstring is close to vertical

Adjustment sheet

1. Adjust the pressure adjustment screw according to the pull saw and pulling force pounds number. Use 3/16 spanner adjust this screw, the max adjust range is 6 rings.

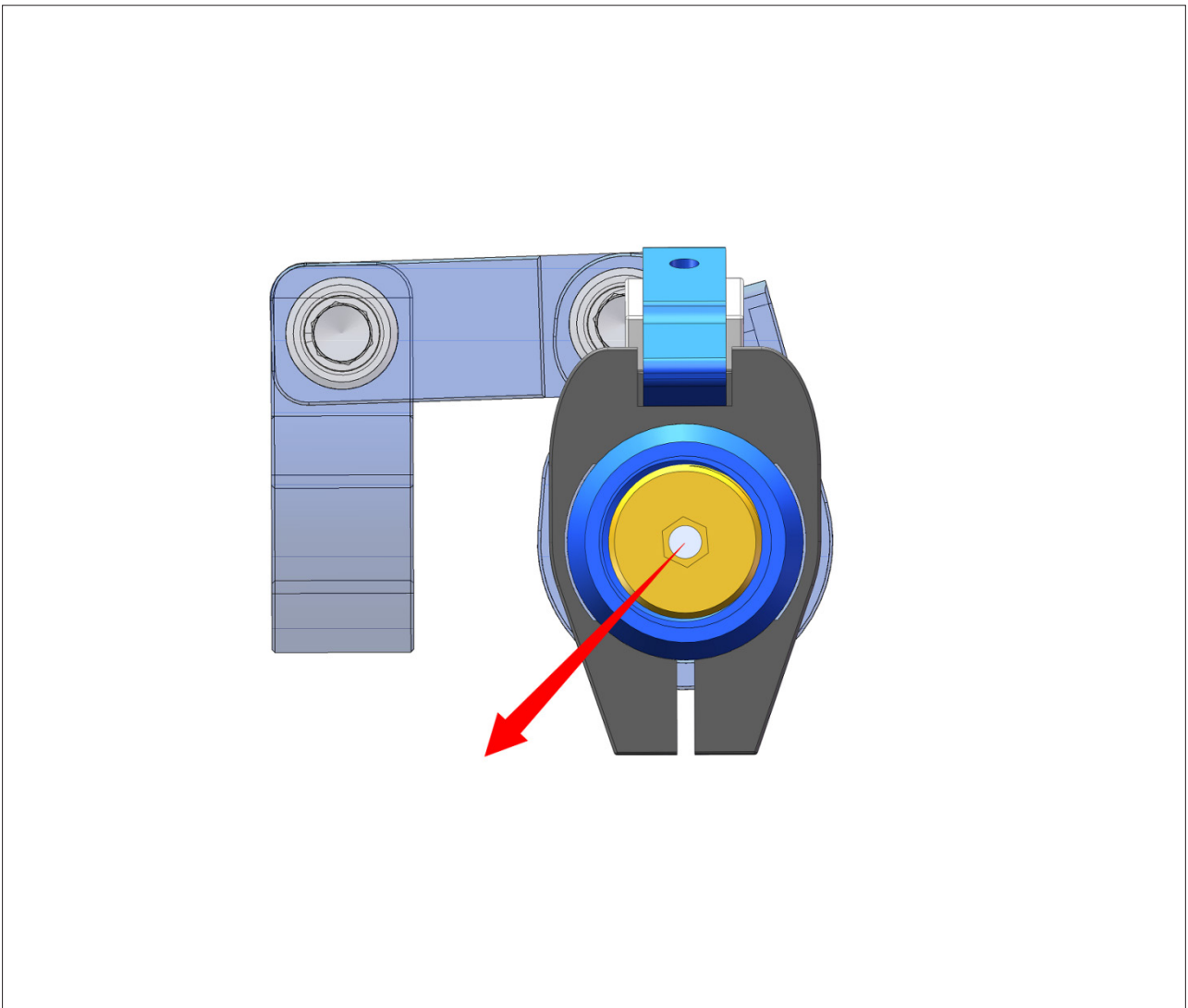

It is 0 ring when anticlockwise revolve to contact shield ring. Clockwise revolve 6 rings is the adjustable max value, then continue revolve maybe caused it damage the seal ring.

2. Please roughly adjust to the below corresponding screw rings first before start to shoot. Please trial shooting from big to small.

The adjustment result subject to that metal part not enter into bow body range when imitate arrow shaft forward motion end after shoot.

◆ **Attention:**

No enough ring number will caused the air pressure resistance not enough, the imitate arrow shaft will has too much forward rushing. This maybe caused it impact base or bow body.

Too much ring number, it will caused too big air pressure resistance, too quick imitate arrow shaft stop and increase vibration.

The roughly adjust data are:

<25 pounds/<27 inch	0-1 ring
25-30 pounds/>27 inch	1-2 rings
30-35 pounds/>27 inch	2-3 rings
35-40 pounds/>27 inch	3-4 rings
>35 pounds/>27 inch	4-6 rings

1. Adjust the position of the clicker system according to your own draw length. The clicker system is fixed by hand screw, which is loosened, moved to a suitable position and locked.



2. When the draw length above 29.5, you can change the position of the 6 # - 32unc screw of the simulated arrow tail and casing, the length of the 0.5 / 1 / 1.5 inch saw can be increased.

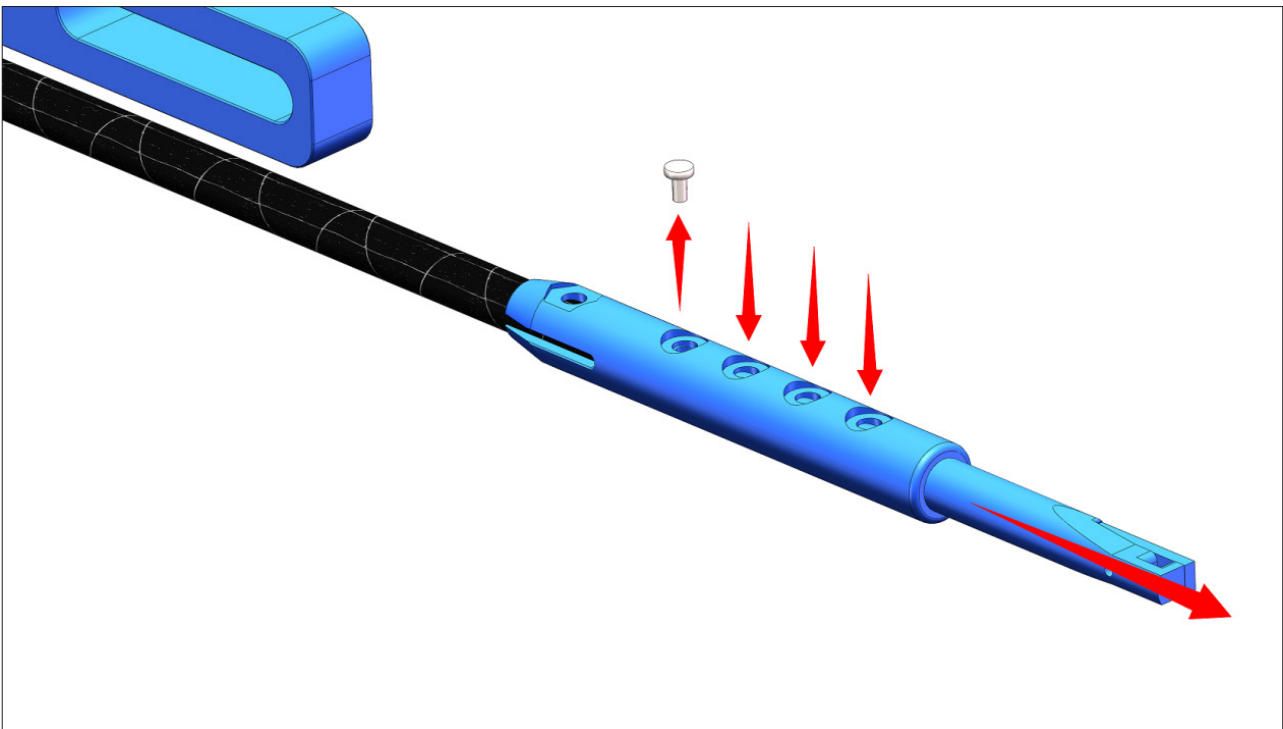

● END